

<p>⚠ WARNING</p> <p>UNINTENDED DEVICE OPERATION</p> <ul style="list-style-type: none">• This device requires advanced knowledge of the application and setting of protection systems.• Only persons with such knowledge should be allowed to configure and set this device. <p>Failure to follow these instructions can result in death, serious injury or equipment damage.</p>
--

- This device requires advanced knowledge of the application and setting of protection systems.
- Only persons with such knowledge should be allowed to configure and set this device.

Failure to follow these instructions can result in death, serious injury or equipment damage.

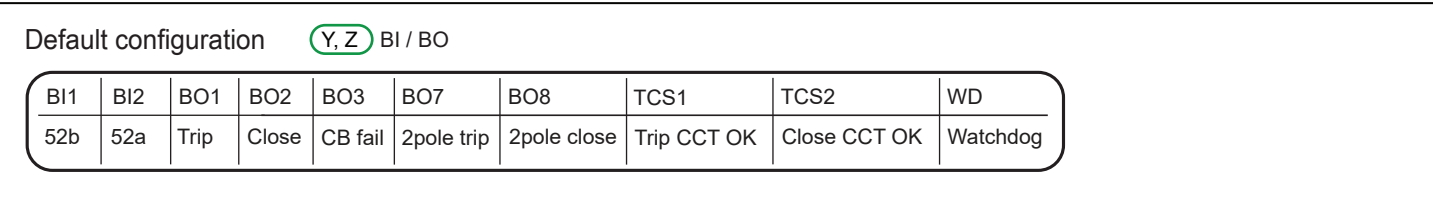

Protection and control device



Schneider Electric Industries SAS
35 rue Joseph Monier
92500 Rueil-Malmaison
France
www.se.com



JYT77075-04

PRODUCT TAMPERING

Failure to follow these instructions can result in compromised confidentiality and authenticity of the information contained in the products.

Product label

Access to product website



 The QR code provides direct access to the product website, where technical data as well as REACH and RoHS declarations are available.

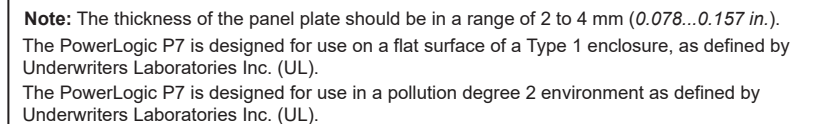

Retain for future use

IMPORTANT NOTE

Electrical equipment should be installed, operated, serviced, and maintained only by qualified personnel. No responsibility is assumed by Schneider Electric for any consequences arising out of the use of this material.

If the device is not immediately installed after receipt, it should be stored in its original packaging in a dry, dust-free area.

- 1 Protection and control device
(max. weight: 9.7 kg/21.3 lb)
- 2 Certificate of Conformity
- 3 Instruction sheet
- 4 Accessory box (top)
 - 4 terminal serial plug
 - CT/VT screws
 - CT/VT jumpers
 - Mounting screws
 - Slot label
 - Optional Ethernet (SFP) module(s)
- 5 Accessory box (bottom)
 - IP20 cover for CT/VT
 - Barrier

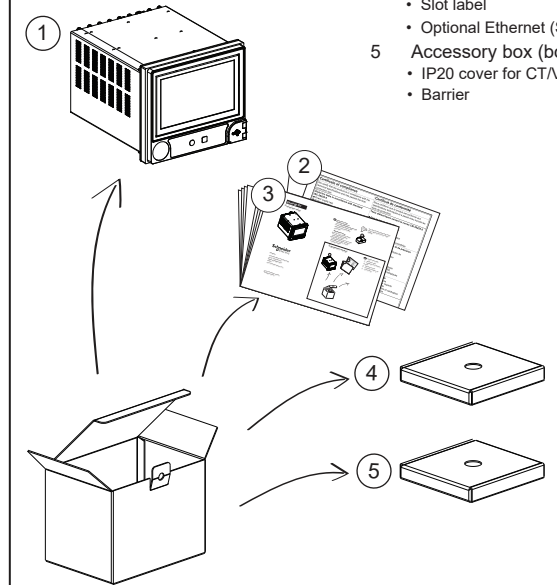

⚠️ DANGER

HAZARD OF ELECTRICAL SHOCK, EXPLOSION OR ARC FLASH

- Turn off all power supplying this equipment before working on or inside the equipment.
- Always use an appropriate voltage detection device to confirm that no voltage is present.
- Replace all devices, doors and covers before switching on power to this equipment.

Failure to follow these instructions will result in death or serious injury.

Example with slots B-C for CT/VT module, slots F and G for DMC and MIO modules

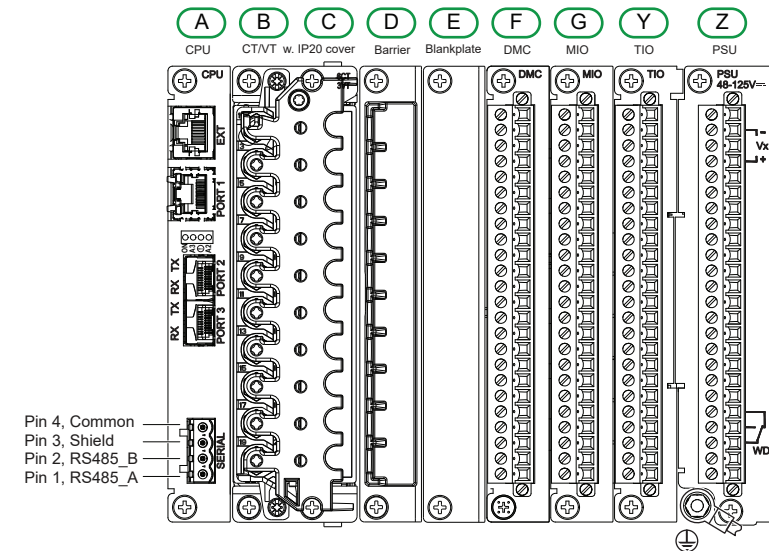

- NOTE:**
- Optional boards (slots D to G) depend on the configuration selected.
 - The IP20 cover and barrier are shown fitted, but are separately provided in the accessory box and need to be fitted manually.

A CPU: Main processor module

- EXT: CAN bus port for connection with additional accessories like IRIG-B/RTD/CLIO module.
- PORT 1: Ethernet port RJ45
- PORT 2/3: Optional SFP modules
 - 100/1000 Mbps RJ45
 - 100 or 1000 Mbps fiber optic multimode
 - 100 or 1000 Mbps fiber optic singlemode
- SERIAL: 2-wire RS485 serial port

B-C CT/VT analog input module - 2 slots

D-E/F-G CT/VT analog input module, optional - 2 slots

D/E/F/G MIO: Mixed I/O module, optional - 1 slot

DMC: Motor control board, optional - 1 slot

Y TIO: PSU auxiliary

Z PSU: Power supply module with binary outputs

PSU: Low range: 24...34 V DC
Mid range: 48...125 V DC
High range: 110...250 V DC/AC 50/60 Hz

CT/VT: 50 Hz or 60 Hz

BI: 24...250 V DC, 220...250 V AC

BO: 8A (UL: 5 A) 250 V AC/DC



WD: 2 A 240 V AC/DC

⚠️ DANGER

HAZARD OF ELECTRICAL SHOCK, EXPLOSION, ARC FLASH AND FIRE

- Connect the device to ground with nut and washer.
- Tighten the terminal screws within the recommended range.
- A maximum of two ring terminals can be used for each terminal on the CT/VT module.
- Protect the power supply circuit against overcurrents.

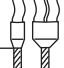
Failure to follow these instructions will result in death or serious injury.

Wiring for CT/VT analog input module		Ø 4 mm 0.16 in. Ø < 10 mm < 0.39 in.	0.5...1.5 mm ² (AWG 20...16) 1.5...2.5 mm ² (AWG 16...14) 2.5...6 mm ² (AWG 14...10)	1...1.2 N•m 8.85...10.62 lb-in	6.5 mm 1/4 in.
Wiring for MIO, TIO, DMC and PSU modules		12 mm 0.5 in.	⊗1 0.2...2.5 mm ² (AWG 24...14) ⊗2 0.2...1.5 mm ² (AWG 24...16)	0.5...0.6 N•m 4.4...5.3 lb-in	3.5 mm 9/64 in.
		Ø 4 mm 0.16 in.	2.5 mm ² 2.5...6 mm ² (AWG 12...10)	1...1.2 N•m 8.85...10.62 lb-in	7mm spanner < 2 m (< 6.5 ft.)

⚠️ WARNING

UNINTENDED DEVICE OPERATION

Replace the terminal blocks in the correct locations after removing them for wiring or testing.

Failure to follow these instructions can result in death, serious injury or equipment damage.

NOTICE

DEVICE DAMAGE

Power off the device before removing or replacing any part or module.

Failure to follow these instructions can result in equipment damage.

Typical CT/VT terminal block cabling procedure (with IP20 cover and barrier)

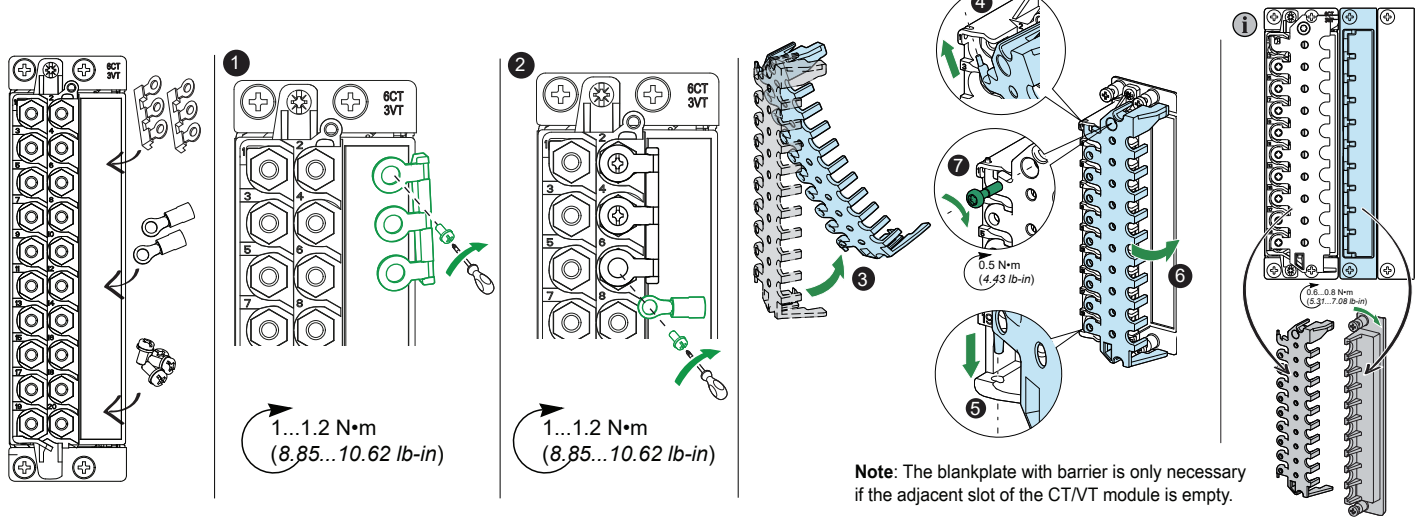

B-C/D-E/F-G 6CT+3VT

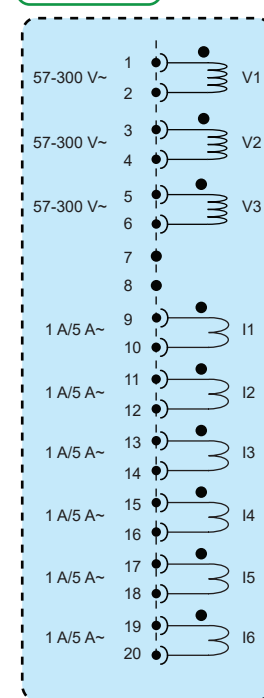

B-C/D-E/F-G 5CT+4VT

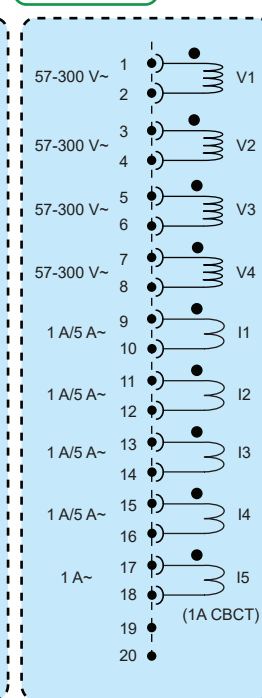

D/E/F/G DMC

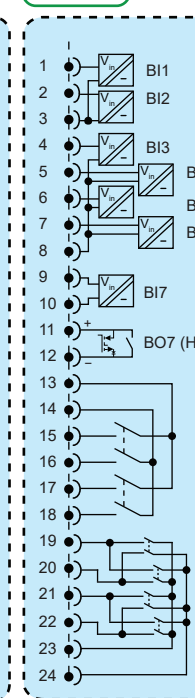

D/E/F/G MIO

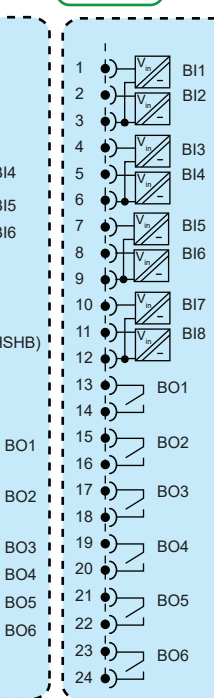

Y TIO

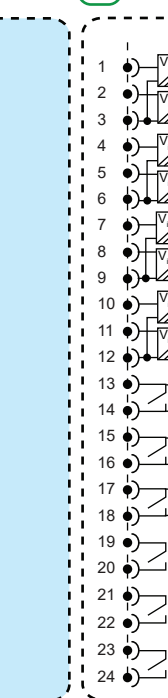

Z PSU

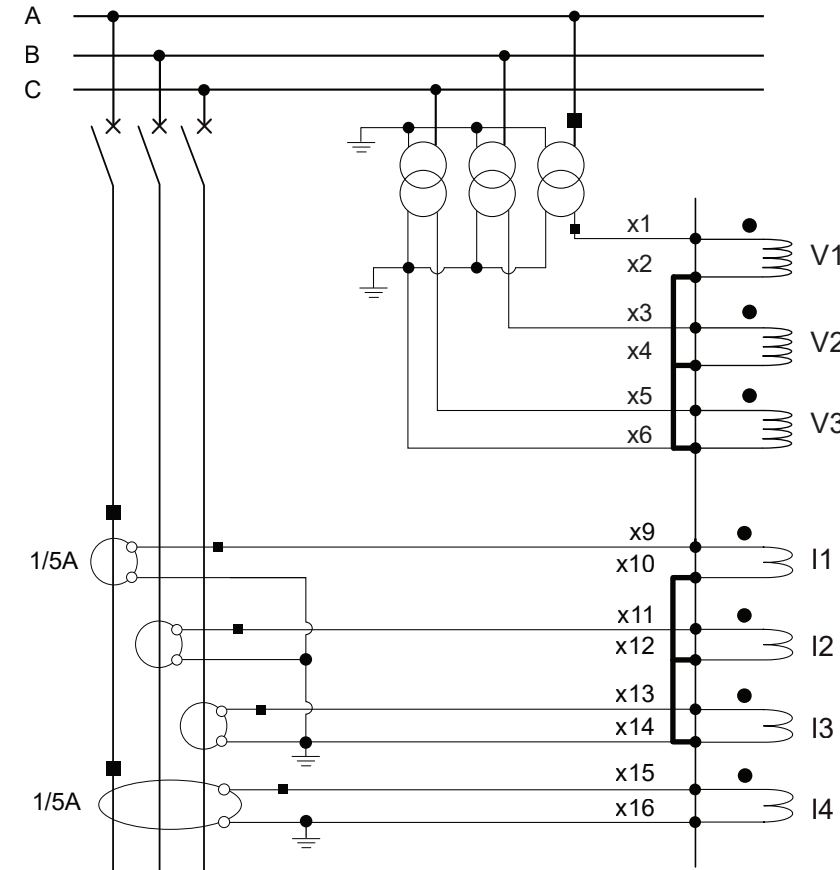
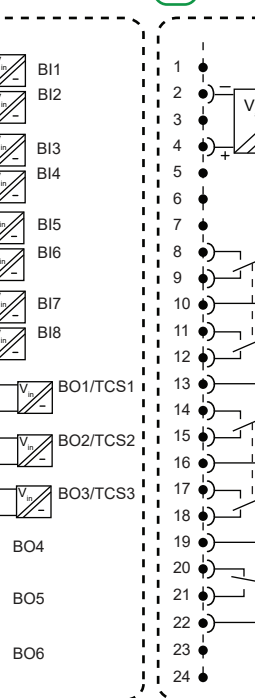

- P1 ■ S1
- Current transformer (CT)
- Voltage transformer (VT)

- Wiring diagrams represent the protection and control device not energized.
- Typical connections for basic applications are shown. Refer to the PowerLogic™ P7 User Manual for other connections.
- The terminal reference x refers to the first slot used by the first analog module which occupies 2 slots. For example, if the first analog module is fitted in slots B & C then x1 becomes B1.
- The mapping shown is typical but needs to be configured by the PowerLogic™ Engineering Suite before using the product.

- BI Binary input
- BO Binary output
- WD Watchdog
- CBCT Core balance current transformer
- TCS Trip Circuit Supervision
- HSHB High Speed High Break
- Terminal
- Optional